

- Extremely resistant, ideal for heavy duty applications
- Construction according to DIN 43697
- Options from 1 to 10 actuators, 12 or 16mm spacing
- Degree of protection IP67
- Pin plunger, roller and sphere plunger actuators
- Internal switch with rating 10A
- Screw terminals
- Optional LED indicator
- Cable entrance with oval hole or thread Pg

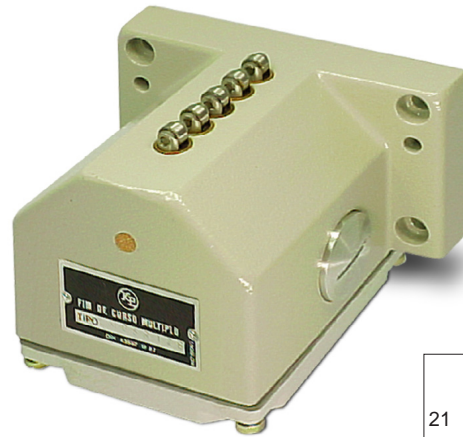

Circuitry

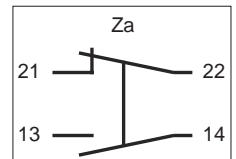

## Specifications

Electrical Rating	10A 250Vac
Contact Resistance	50mΩ maximum initial (at 1A 5Vdc)
Ambient Temperature	+85°C maximum
Operating Speed	1,7mm/sec minimum to 1m/sec maximum (30° cam)
Degree of Protection	IP 67 (EN 60529)
Internal Switch	Circuit Form Za (IEC 60947-5-1): same polarity
Mechanical Life Expectancy	10.000.000 cycles
Electrical Life Expectancy	200.000 cycles
Materials	Enclosure: Die cast Aluminium
	Actuators: Stainless steel

## Ordering Information

**L M 0 2 D 1 2 B** ①

<b>Series</b>		<b>Cable Entrance</b> ②	
		With PG Thread = B	
		With Oval seal = C	
<b>Nº of Actuators</b>		<b>Actuator Spacing</b>	
1 Actuator = 01		12mm between actuators = 12	
2 Actuators = 02		16mm between actuators = 16	
3 Actuators = 03		<b>Actuator Type</b>	
4 Actuators = 04		Chanfer Pin Plunger = D	
5 Actuators = 05		Roller Plunger = R	
6 Actuators = 06		Sphere Plunger = K	
8 Actuators = 08			
10 Actuators = 10			

Switch for Replacement  
**LM4**

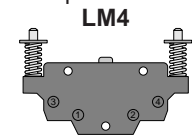

Cable Gland  
(See Catalog ZA)



### Notes:

① For indicator light with LED, add to the code: **Q0** - LED 6Vac/Vdc; **Q1** - 12Vac/Vdc; **Q2** - 24Vac/Vdc; **Q3** - 48Vac/Vdc; **Q5** - 110Vac e **Q6** - 220Vac

② Cable Entrance **metric thread**: consult factory for availability

## Dimensions

### Multiple (DIN 43697)

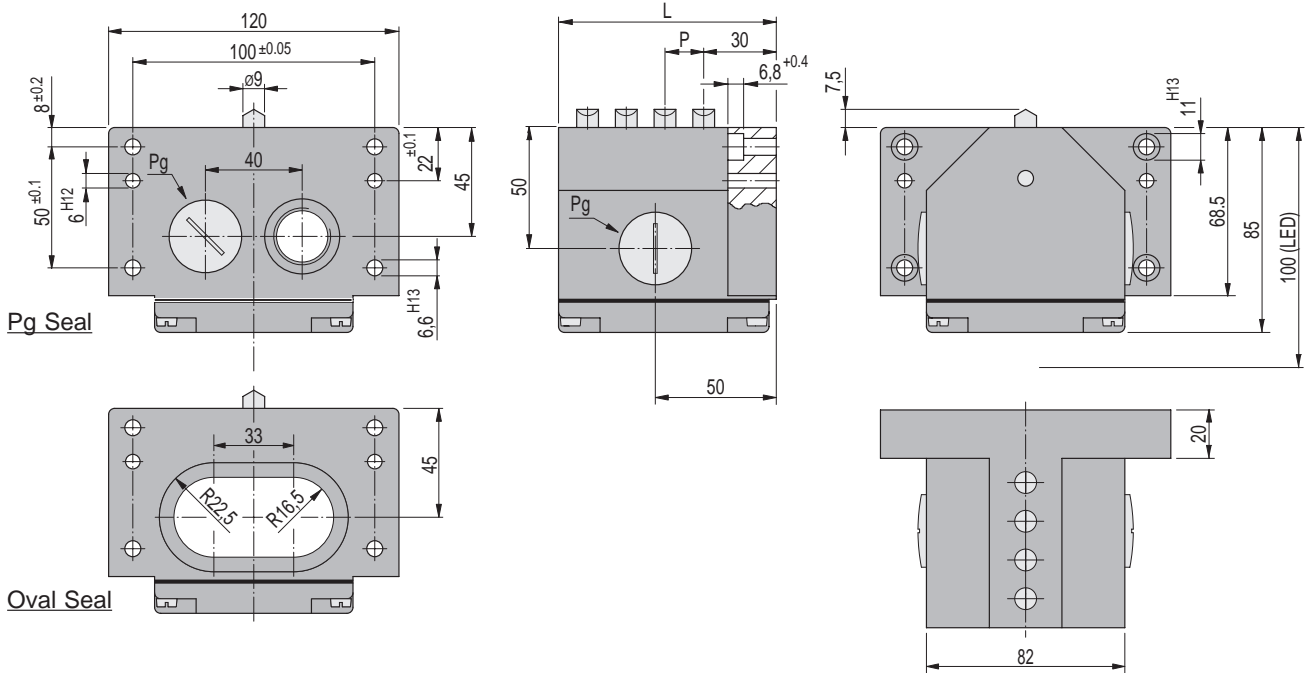

Subject to change without prior notice

Actuators	Actuator Spacing (P)	L	Pg
2	12	70	16
2	16	70	16
3	12	90	16
3	16	90	16
4	12	90	16
4	16	105	16
5	12	105	16
5	16	120	16
6	12	120	21
6	16	140	21
8	12	140	21
8	16	170	21
10	12	170	21

### 1 Actuator (DIN 43693)

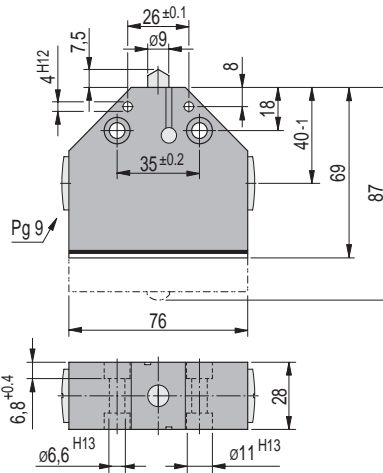

### Type of Actuators

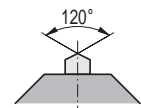

Chanfer

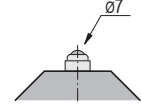

Sphere

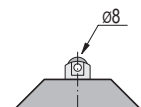

Roller

## Characteristics

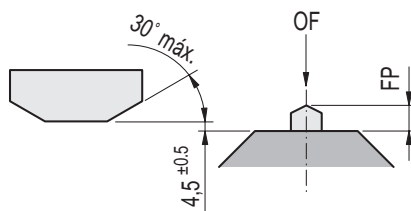

### Course Diagram

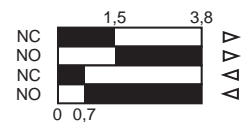

Operating Force (OF)	800g max.
Free Position (FP)	7,5±0,2 mm
Operating Position (OP)	6.0±0.1mm
Diferential Travel (DT)	0.8mm max.
Overtravel (OT)	2.3mm min.