

- High resistant plastic enclosure
- 1 or 2 contact blocks
- Double break circuit with 1NO + 1NC or 2NO + 2NC
- Positive opening NC contact (IEC 60947-5-1)
- Long life mechanism
- Fool proof protection cover
- Cable entrance with Pg13.5 thread
- Screw terminal with retractable clamp
- Rubber feet against sliding
- Modular multiple foot switches
- Double insulated 
- In conformity with Low Voltage Directive 2006/95/EC
- Contact block UL approved (File E131787)

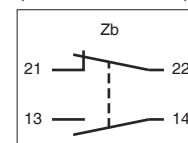

Product
CE

Circuitries
(IEC 60947-5-1)



1 contact block

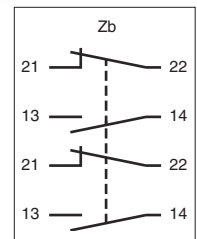

2 contact blocks

Specifications

Utilization Category (IEC 60947-5-1)	AC-15	DC-13
Rated Operational Voltage (Ue)	400 V	125 V
Rated Operational Current (Ie)	4 A	1,1 A
Rated Insulation Voltage (Ui)	500 V	600 V
Rated Thermal Current (Ith)	10 A	
Contact Resistance	50 mΩ maximum initial (at 1 A 5 Vdc)	
Insulation Resistance	100 MΩ minimum (at 500 Vdc)	
Ambient Temperature	-25° C ... +80° C	
Degree of Protection	IP53 (IEC 60529)	
Contact Block	Circuit Form Zb (IEC 60947-5-1) with double gap: NO and NC contacts can be independent circuit	
	With positive opening operation on NC Contact (IEC 60974-5-1): when the foot switch is totally actuated	
Mechanical Life	10.000.000 cycles	
Electrical Life	50.000 cycles	
Materials	Housing:	Reinforced Thermoplastic
	Actuator:	Reinforced Thermoplastic
	Protection Cover:	Reinforced Thermoplastic

Dimensions (in mm)

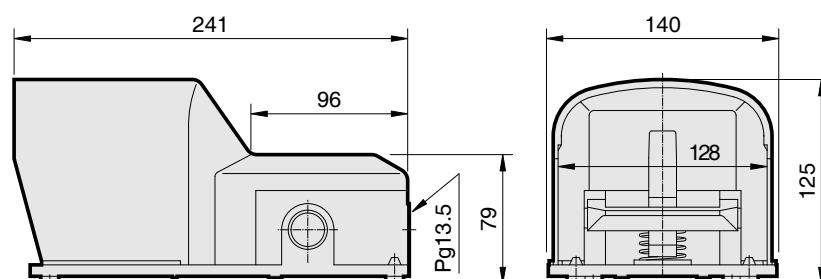

Safety Lever

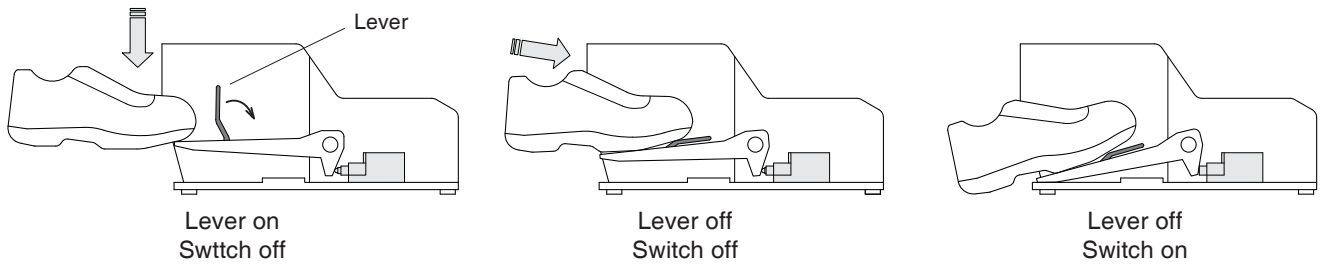

Ordering Information

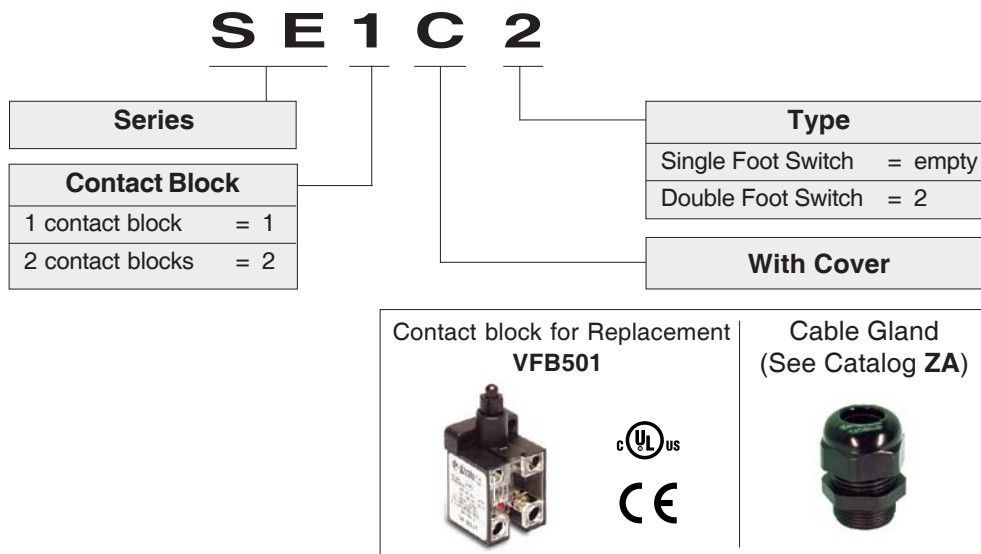

Modular Multiple Foot Switch

The double foot switch can be purchased already assembled: **SE1C2** (2 foot switches with 1 contact block each) or **SE2C2** (2 foot switches with 2 contact blocks each).

For modules with more than 2 foot switches, acquire foot switch unit (**SE1C** and / or **SE2C**) and the devices of union needed (**VFKIT20**). The union is setting itself the device between two foot switches.

The carrying rod (**VFKIT22**) is marketed separately.

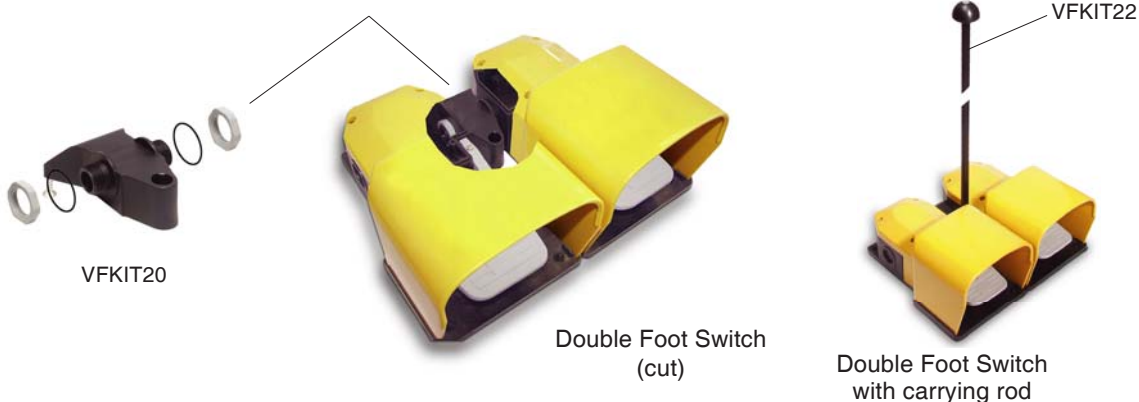

Special Applications

The products presented in this catalog are models of regular commercial use, however we are able to develop "personalized" models for special applications. Contact us.

